

## RACCORDERIA INOX 304 - 316 FILETTATA DA MICROFUSIONE

### GOMITO 90° MF - AISI316

ISO228			CODICE
1/2"			12R316_MCR_GOM_1/2



### GIUNTO 3 PEZZI - ISO228 FF - AISI316

ISO228			CODICE
3/8			12R316_MCR_BOC_3/8
1/2			12R316_MCR_BOC_1/2
3/4			12R316_MCR_BOC_3/4
1"			12R316_MCR_BOC_1"
1"1/4			12R316_MCR_BOC_1"1/4
1"1/2			12R316_MCR_BOC_1"1/2
2"			12R316_MCR_BOC_2"

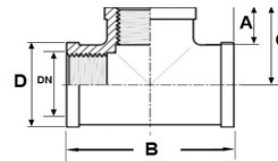

### TEE FILETTATO FEMMINA - AISI316

ISO228	A	B	C	D		CODICE
1/4"						12R316_MCR_TEE_10
3/8"						12R316_MCR_TEE_11
1/2"	13,5	54	27	27		12R316_MCR_TEE_15
1"	13,5	67	33,5	40		12R316_MCR_TEE_25
1"1/4	17	84	42	50		12R316_MCR_TEE_32
1"1/2	19	96	48	58		12R316_MCR_TEE_40
2"						12R316_MCR_TEE_50

Ultimi articoli sostituiti da microfusione

### RIDUZIONE MASCHIO PER FEMMINA ISO 228 CILINDRICO AISI316

ISO228 MxF Dxd	W	H	L	CODICE
1/4X1/8				12R316_MCR_RI1008
3/8x1/8				12R316_MCR_RI1108
3/8X1/4				12R316_MCR_RI1110
1/2x1/8				12R316_MCR_RI1508
1/2X1/4				12R316_MCR_RI1510
1/2X3/8				12R316_MCR_RI1511
3/4x1/4				12R316_MCR_RI2010
3/4X3/8				12R316_MCR_RI2011
3/4X1/2				12R316_MCR_RI2015
1"X1/4				12R316_MCR_RI2510
1"x3/8				12R316_MCR_RI2511
1"X1/2	37	20,5	28,5	12R316_MCR_RI2515
1"X3/4				12R316_MCR_RI2520
1"1/4x1/2"	45	21	30	12R316_MCR_RI3215
1"1/4x3/4				12R316_MCR_RI3220
1"1/4X1"				12R316_MCR_RI3225
1"1/2x3/4"	49	20	35	12R316_MCR_RI4020
1"1/2x1"1/4				12R316_MCR_RI4032
2"x1/2				12R316_MCR_RI5015
2"X3/4				12R316_MCR_RI5020

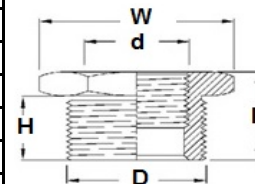
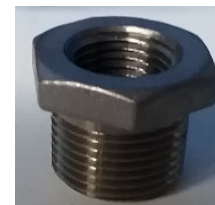

**SATEMA**

13856 VIGLIANO B.SE - Via Milano, 395

Tel. +39 015811102 - Fax 0158853029

Mail: [info@satema.it](mailto:info@satema.it) <http://www.satema.it>

12\_147\_1